



innovative
sustainable
solutions

COMPANY PROFILE
Architecture | Urban Design
May 2014

www.argdesign.co.za

CONTENTS

COMPANY PROFILE	1
SERVICES PROVIDED	1
PARTNERS & TEAM	2
ARG PARTICULARS	3
CONTACT DETAILS	4
CLIENT PROFILE	5
PROJECT GALLERY	7

COMPANY PROFILE

ARG Design is committed to mainstreaming regenerative design and development throughout the built environment.

We have designed and delivered many major projects and have been recognised through various awards including:

- Three Cape Institute for Architecture Commendation Awards
- Sustainable Building Best Practice (Community Category) Award and
- Holcim International (Middle East and Africa) Sustainable Project Prize.

INTEGRATED DESIGN is critical to sustainability. ARG's practice combines the professions of urban design, city and regional planning and architecture. We also work in association with key professionals in energy efficiency, waste management and cost planning to provide optimum service to our clients.

We believe in providing a professional service, on site and in budget.

ARG Design is registered with the South African Institute of Architects and its partners and employees are registered with the South African Council for the Architectural Profession (SACAP), the Cape Institute for Architects, The South African Council for Planners (SACPLAN) and the Urban Design Institute of South Africa (UDISA).

SERVICES PROVIDED

URBAN DESIGN: (Local + Macro) full service including:
Spatial development frameworks
Building Guidelines
Site Development etc.

TOWN / CITY PLANNING: (Local + Macro)
Rezoning, subdivisions etc.

ARCHITECTURAL SERVICES: Full + supplementary
Sustainable Design

PARTNERS & TEAM

GITA GOVEN
CEO

Gita Goven is one of South Africa's foremost sustainability thinkers, Architect and Sustainable Design practitioners. As founding partner and CEO of ARG Design, she has pioneered a practice of socially and environmentally transformative design.

Gita completed her Bachelor of Architecture in 1986 at University of Cape Town and has worked on sustainable design and development projects since 1981.

Gita leads the cross disciplinary work in ARG Design, and is responsible for research, design integration, marketing, building networks and partnerships for the delivery of sustainable innovation through projects.

ALASTAIR RENDALL
Managing Director

Alastair Rendall is a founding partner of ARG Design. He completed his Bachelor of Architecture at the University of Cape Town in 1985 and a Master of City Planning and Urban Design in 1989.

His combination of private practice and NGO-experience has been brought to bear on the delivery of high-quality public sector projects that win community, client and public acceptance.

ISTVAN GOSZTOLA
Design Director

Istvan provides the design leadership of all projects in ARG Design. Istvan graduated with a Bachelor of Architecture in 1987 from the University of Port Elizabeth and a Master of City Planning and Urban Design in 1989 from University of Cape Town.

ARG Design has a team of 15 full time staff and a pool of 6 contract staff who work closely with fellow consultants to deliver our clients briefs; addressing environmental, social and economic sustainability.

ARG PARTICULARS

ARG Design is a Black Empowerment Enterprise owned by Gita Goven (70%), Alastair Rendall (15%) and Istvan Gosztola (15%). 50% of our staff is black and 60% women. ARG Design was established in 1999 and has been in operation for the past 14 years.

We use state-of-the-Art 3D design and modelling software on the latest Apple Macintosh computers to maximise the time we spend on design development and minimize time spent on drawing production.

The members of our practice have also been trained to use the green building assessment tools of the Green Building Council of South Africa.

Company Registration Number: 1999/035278.23
Tax Reference Number: 9498038034
VAT Reference Number: 4750183875

Professional Indemnity Insurance

Name: Stalker Hutchison Admiral (Pty) Ltd
Sum insured: R85m
Excess: R50 000

CONTACT DETAILS

Physical Address:

ARG Design, 409 Premier Centre, 451 Main Road, Observatory, 7925

Postal Address:

ARG Design, PO Box 13936, Mowbray, 7705

Tel: 021 448 2666
Fax: 021 448 2667
Contact: NURAAN KAHAAAR
Practice Manager

studio@argdesign.co.za
www.argdesign.co.za

CLIENT PROFILE

URBAN DESIGN
& ARCHITECTURE

KAGISO	SA Pavilion, World Sustainability Summit - Zaragoza, Spain Telkom 25 year Exhibition - Pretoria
NECSA (Nuclear Energy Commission South Africa)	Pelindaba Visitors Center, New Corporate Office (in progress), New Science Center (in progress)
FIFA	Red Carpet Opening Event and Exhibition
LAZER	New Stuttafords Head Office - Epping, Cape Town, New Stuttafords Warehouse - Epping, Cape Town, New Lazer Head Office, Refurbishments - Epping, Cape Town, New Lazer Corporate Offices and Parking (in Progress)
SPIER ESTATE	Lynedoch Community hall and Primary School Lynedoch Sustainable Village
CAPE TOWN SCIENCE CENTER	New corporate offices, shops and science center - Observatory, Cape Town
MEMORY INC	Motala Museum Exhibit - Maputo, Mozambique
MARCUS EVANS SOUTH AFRICA	Matador Centre - 65 Strand St, Cape Town
PROVINCIAL GOVERNMENT WESTERN CAPE	Malmesbury Community Health Centre Table View Primary School
NATIONAL DEPARTMENT OF HOUSING	Hillview Informal Settlement Upgrade
CITY OF CAPE TOWN	BRT, MyCiti bus stations Monwabisi Spatial development Framework Somerset Hospital Precinct Urban Design Framework Tsoga Environmental Centre Blue Downs Swimming Pool

CLIENT PROFILE

URBAN DESIGN
& ARCHITECTURE

CITY OF RUSTENBURG	BRT bus stations Center City Urban Design RRT Central Station
CITY OF EKURHULENI	BRT Bus stations Bus Depots Head Office
UCT	Menzies Refurbishments and Additions
RBA	Protea Glen Village, 1000 unit affordable Housing Development, Soweto
SANCCOB TRUST	Sanccob Centre for The Southern African Foundation for the Conservation of Coastal Birds (in progress)
FIFA & ARCHITECTURE FOR HUMANITY	Football For Hope Centre
NEW WORLD CINEMA	Refurbishment of offices, Fringe, Cape Town
ABSA BANK	Refurbishment of banking Hall, additions and alterations, Sea Point (with Stucke Harrison Architects)
BELLANDIA	Wescap Settlement City Extension
INFRAMAX	Refurbishment, additions, alterations to create new mixed used development at Sunrise Circle, Epping
RESTAURANTS	Jade Lotus, London Sauls, Sea Point Sleepy Vine, Sea Point Wimpy, Sea Point
PRIVATE CLIENTS	Over 25 Luxury residences manly on the Atlantic Seaboard but also further afield in Alderney, Channel Islands, refurbishments to residence in Tuscany, Italy, holiday homes in Lamberts Bay, Pringle Bay, Cape St. Francis, Port Elizabeth.

PROJECT GALLERY

ARCHITECTURE

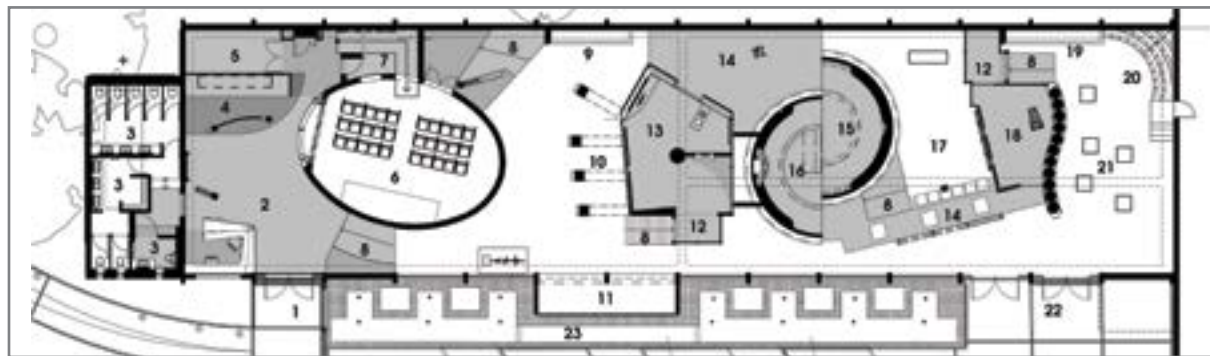

Barmaran
Clifton Bugalow
Football for Hope
NECSA Visitor Centre
House Muller

PROJECT GALLERY

ARCHITECTURE



Malmesbury Community Health Centre
Barmaran
MyCiti Stadium Station
MyCiti Airport Station
NECSA Visitor Centre

PROJECT GALLERY

URBAN DESIGN
& PLANNING



Mfuleni Urban Node Precinct
N2 Gateway
Wescap

PROJECT GALLERY

URBAN DESIGN
& PLANNING



Milnerton Local Area Plan
Milnerton Local Area Plan
Wescap

